

Supplement Installation Instructions

H300 Entry / Comfort

Water leakage caused by twisted main seal

If the main seal becomes twisted during the installation of the sunroof module, it can cause water leakage.

- ▶ Check the main seal for correct seal by inspecting it around the glass panel.
- ▶ Make sure the main seal is not twisted (see Fig. 01).
- ▶ In case of a twisted main seal, push the main seal gently under the roof molding using a plastic panel removal tool (see Fig. 02).

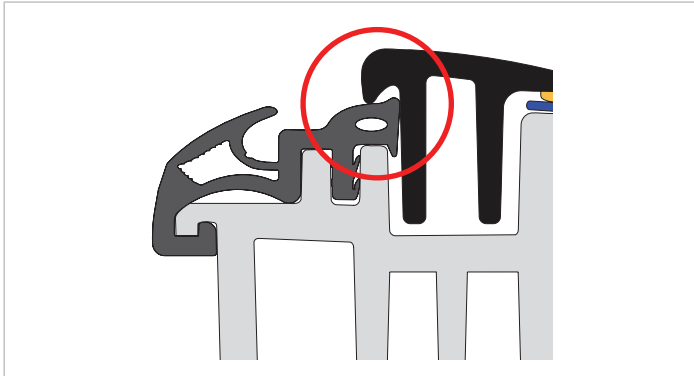

Fig. 01: Cross section of a correctly placed main seal

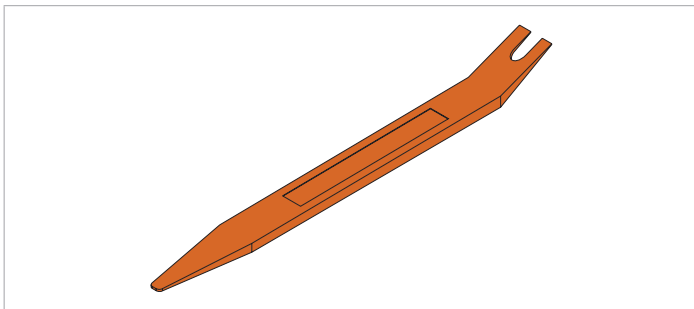

Fig. 02: Example of a panel removal tool.

Water leakage caused by loose hydrophobic seal on roof skin

In applications with a strongly curved roof skin the hydrophobic seal can detach from the roof skin during cleaning the car with extreme high water pressure from a distance < 8 inch (200 mm).

- ▶ Before placing the roof molding, apply a small layer of butylane sealant (or equivalent) at the edge of the front corners of the roof molding, outside the hydrophobic seal (see Fig. 03).

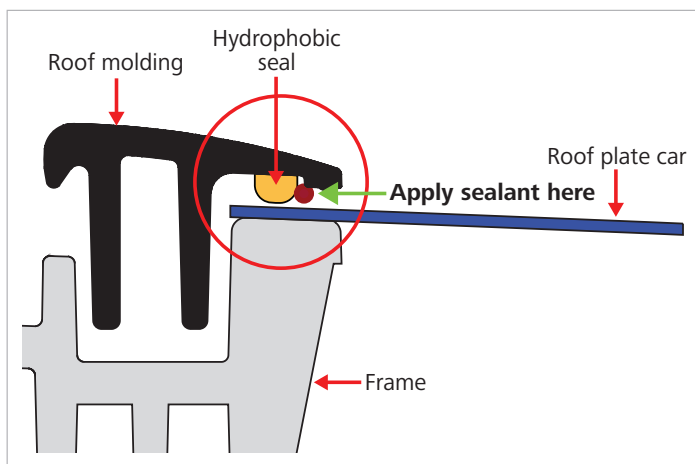

Fig. 03: Location of additional butylane sealant

Aesthetic interior finish

A gap between the trim-shell carrier and the original headliner is not acceptable.

- ▶ Eliminate the gap (Fig. 04) by using the tips and tricks which can be found on the technical portal: dealers.webasto.com or www.techwebasto.com.



Fig. 04: Properly adjusted trim-shell carrier

Support brackets

Some cars have a thin roof skin or there is much roof skin left on either side of the sunroof. This can cause vibration and / or collapsing of the roof skin.

- ▶ Install support bracket (Fig. 05) to reinforce the car roof skin. See the technical portal dealers.webasto.com or www.techwebasto.com for more information.

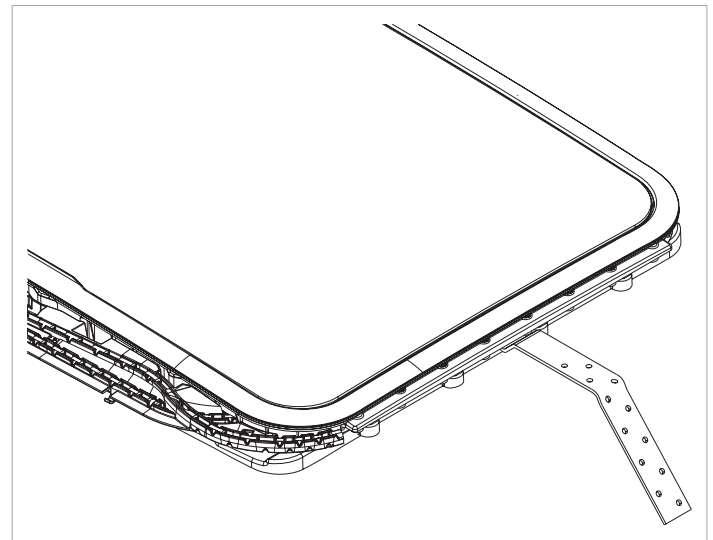

Fig. 05: Support bracket placed to reinforce the car roof skin